

THE LONDON RESORT

The London Resort Development Consent Order

BC080001

Environmental Statement Volume 3: Figures

Figure 3.2 – Land Use Plan

Document reference: 6.3.3.2

Revision: 00

December 2020

Planning Act 2008

The Infrastructure Planning (Applications: Prescribed Forms and Procedure) Regulations 2009

Regulation 5(2)(a)

The Infrastructure Planning (Environmental Impact Assessment) Regulations 2017

Regulation 12(1)

[This page is intentionally left blank]

DO NOT SCALE

Ref. 6.3.3.2



SECTION A-A
REFER TO NOTE 11

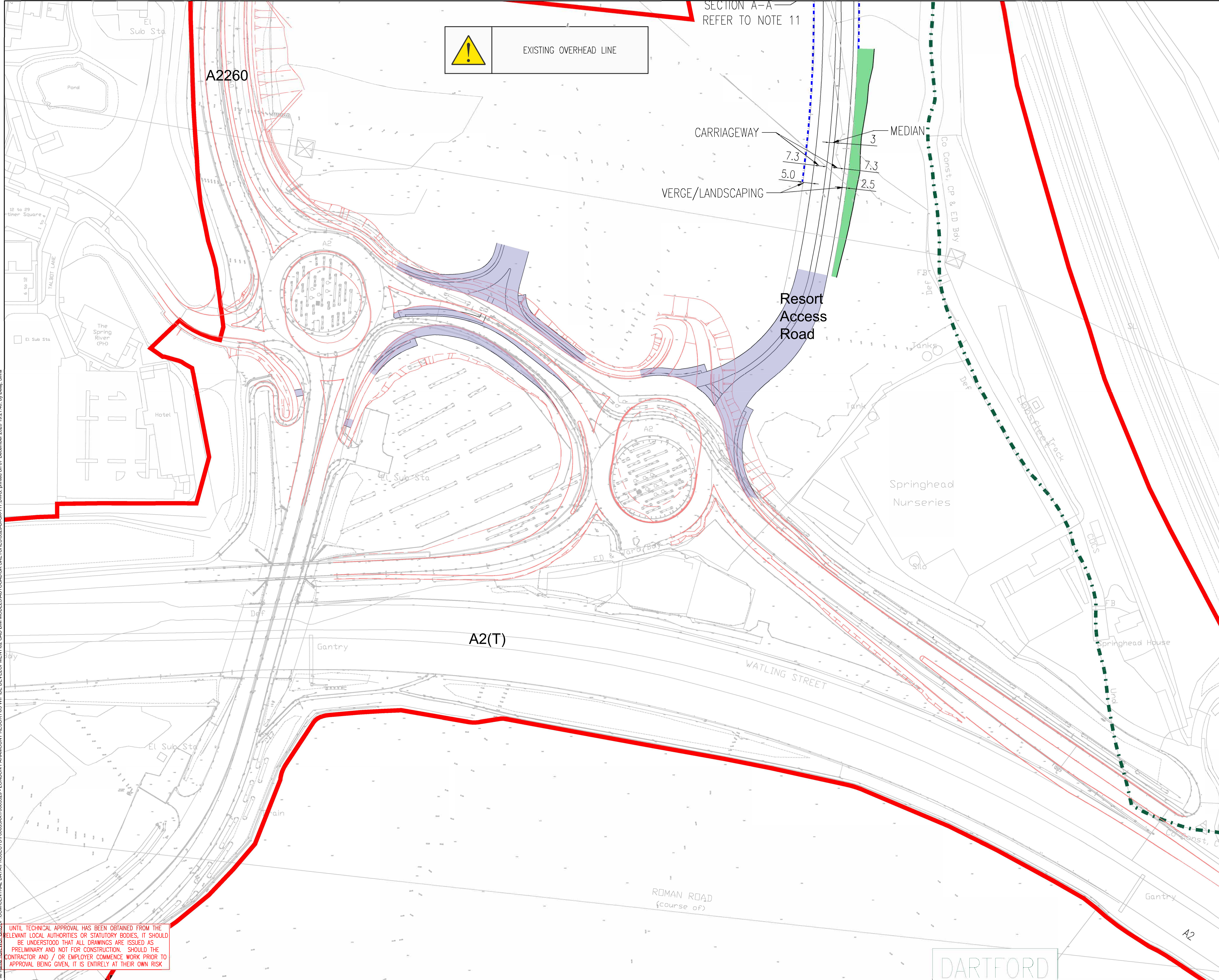
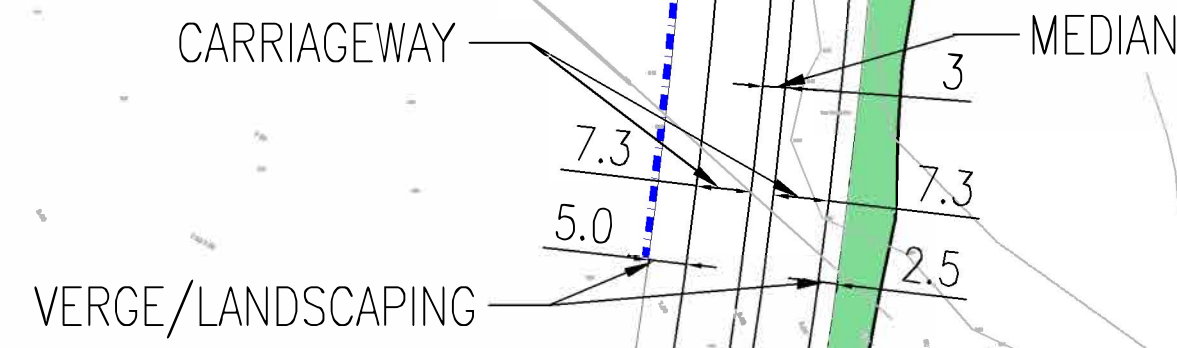

P01	07/12/2020	SB	FIRST ISSUE	95	95
REV	DATE	BY	DESCRIPTION	CHK	APP

DRAWING STATUS: S2 - FOR INFORMATION

Grosvenor House, 2 Grosvenor Square, Southampton, SO15 2BE, UK
T+ 44 (0) 2380 101 700
wsp.com

CLIENT: LONDON RESORT

ARCHITECT: APT

SITE/PROJECT: THE LONDON RESORT

TITLE: Proposed junction of the A2(T) and the London Resort Access Road

SCALE @ A1: 1:500	CHECKED: SD	APPROVED: SD
PROJECT NO: 70063529	DESIGNED: SB	DRAWN: SB
		DATE: Oct 20

DRAWING NO: 3529-DI-SK-117 REV: P01

© WSP UK Ltd

File: \\na101\uk\wsp\groupp\central\data\project\70063529 - LONDON PARAMOUNT RESORT\03\WIP\DEVELOPMENT\02 CAD BIM MODELS\AUTOCAD\SKETCHES\3529-DI-SK-117.DWG, printed on 07 December 2020 10:21:40, by Beilij, Silva

UNTIL TECHNICAL APPROVAL HAS BEEN OBTAINED FROM THE RELEVANT LOCAL AUTHORITIES OR STATUTORY BODIES, IT SHOULD BE UNDERSTOOD THAT ALL DRAWINGS ARE ISSUED AS PRELIMINARY AND NOT FOR CONSTRUCTION. SHOULD THE CONTRACTOR AND / OR EMPLOYER COMMENCE WORK PRIOR TO APPROVAL BEING GIVEN, IT IS ENTIRELY AT THEIR OWN RISK